

# S P E C I F I C A T I O N S

## Tower- J

- ▶ 3 BHK 101 : 1280 Sq.ft.
- ▶ 3 BHK 102 : 1426 Sq.ft.
- ▶ 3 BHK 103 : 1252 Sq.ft.

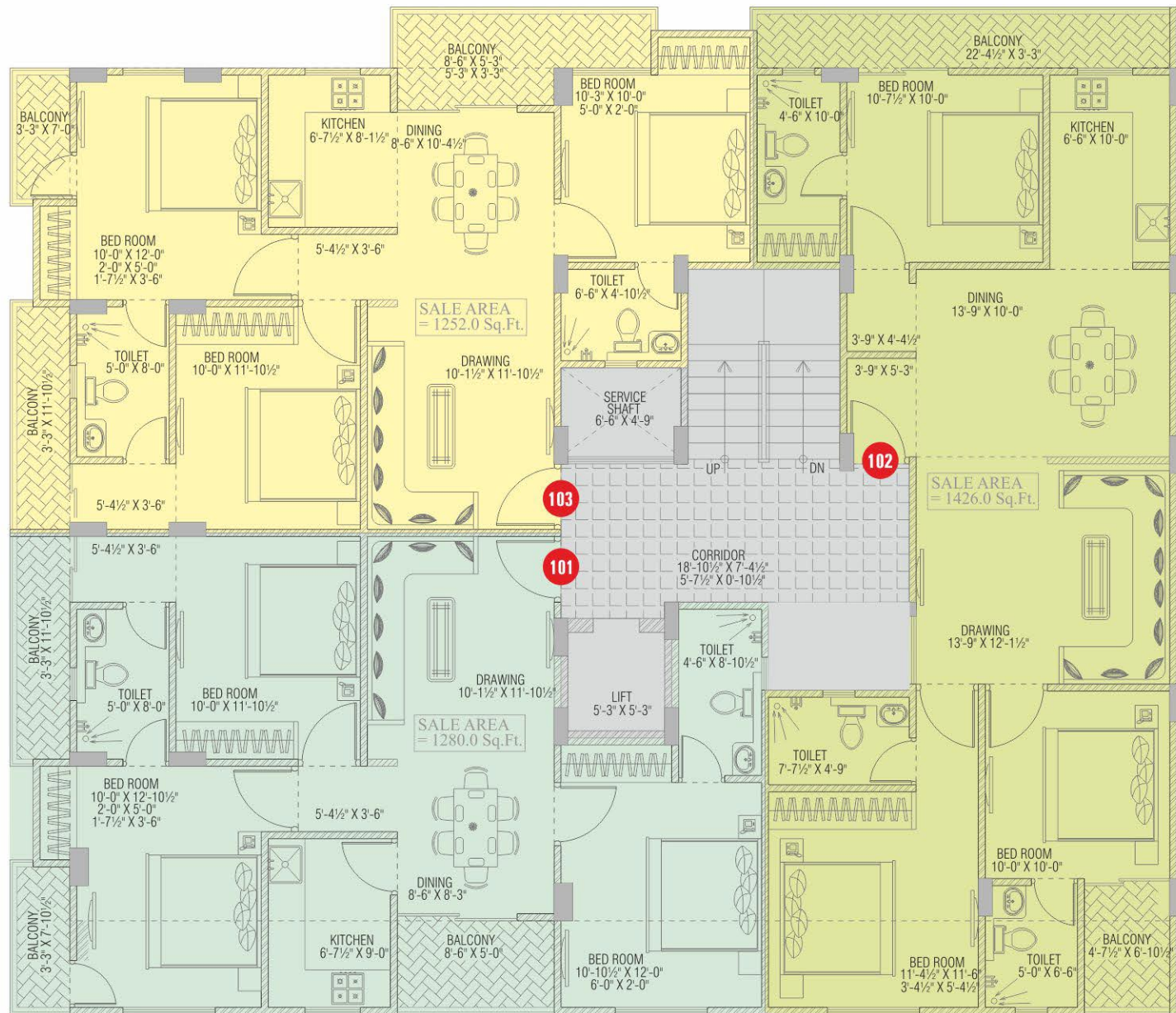
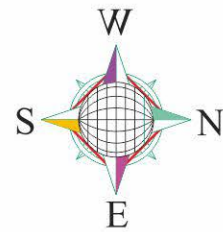

ROAD

TYPICAL 1st TO 4th FLOOR PLAN

ROAD

### DRAWING/DINING

- Vitrified tile flooring
- Flush door
- Aluminium/UPVC windows
- Texture paint
- Modular electrical switches
- Copper piping for AC
- False Ceiling

### BALCONY & TERRACE

- Anti-skid tile flooring
- M.S./S.S. railing

### BEDROOMS

- Vitrified tile flooring
- Flush door
- Aluminium/UPVC windows
- Plastic paint
- Modular electrical switches
- Copper piping for AC

### KITCHEN

- Vitrified tile flooring
- Granite counters
- Modular kitchen
- Gas pipe line
- SS sink
- Aluminium/UPVC door-windows
- Modular electrical switches
- Plastic paint
- Chimney, Geyser, RO

### OTHERS

- Common area-tile/stone flooring
- External-texture paint
- M.S./S.S. railing

### WASH ROOM

- Anti-skid tiles flooring
- Flush door
- Sanitary ware of Jaguar/Equivalent
- Plastic paint

## NOTES